

**Technical Data // Series 1053**

Non-Rotating Test Probe 160 mil / 4.0 mm

HIGHLIGHTS

Anti-turn feature ensures forced guidance between plunger and barrel

Knurled section on the barrel guarantees secure fit of the test probe

MECHANICAL DATA

Center	4.00 mm/160 mil
Temperature range	-30 °C - +120 °C
Full travel	5.00 mm
Working travel	4.00 mm
Pre-loaded spring force	0.50/ 0.80/ 1.25 N
Spring force at working travel	1.50/ 3.00/ 5.00 N

ELECTRICAL DATA

Max. current rating	8.0 A
Typical continuity resistance	<= 30 mOhm

MATERIALS

Barrel	Brass, gold-plated
Spring	Spring Steel, Stainless Steel, gold-plated
Plunger	CuBe
Receptacle	Brass, gold-plated

RECOMMENDED DIAMETER OF DRILL

HP 2361.1 (trolitax)	3.00 mm
HGW 2372 (glass filled material)	3.00 mm

HIGH-TEMPERATURE APPLICATIONS

Temperature range	-40 °C - +250 °C
Pre-loaded spring force	0.50 N
Spring force at working travel (order index E)	1.50 N



Technical Data // Series 1053

Non-Rotating Test Probe 160 mil / 4.0 mm

TIP STYLE - DIAMETER - PLATING

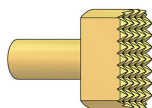

CY
6.00 x 3.00C Au

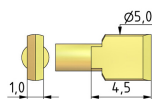

Y
5.00 x 1.00C Au
5.00 x 1.00C Ni

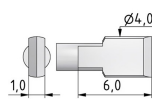

Y4
4.00 x 1.00C Ni

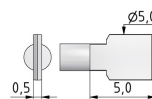

Y3
5.00 x 0.50C Ni

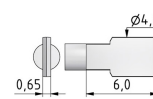

Y5
4.00 x 0.65C Ni

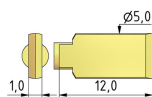

Y8
5.00 x 1.00C Au

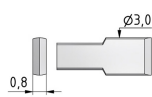

Y10
3.00 x 0.80C Ni

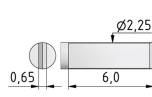

Y11
2.25 x 0.65C Ni

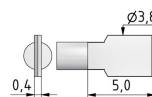

Y14
3.80 x 0.40C Ni

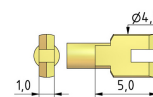

Y15
4.50 x 1.00C Au

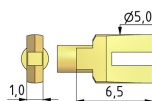

Y16
5.00 x 1.00C Au



Technical Data // Series 1053

Non-Rotating Test Probe 160 mil / 4.0 mm

1053-Y
(also for Tip Styles
Y4 / Y15 / CY)

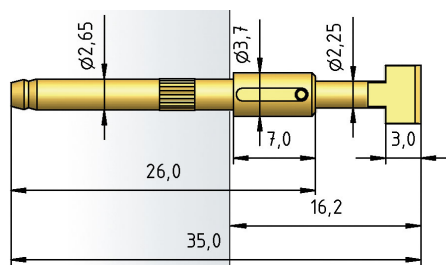

1053-Y8

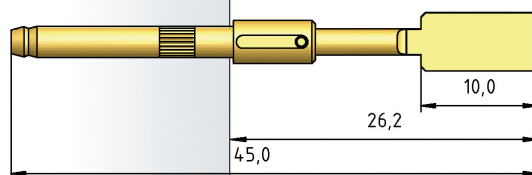

1053-Y16

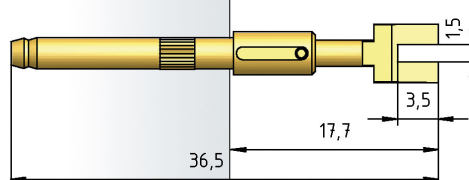

1053-Y3
(also for Tip Styles
Y5 / Y10 / Y11 / Y14)

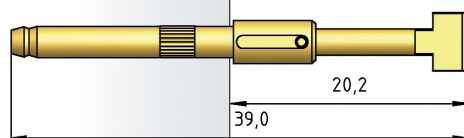

H 1050 L

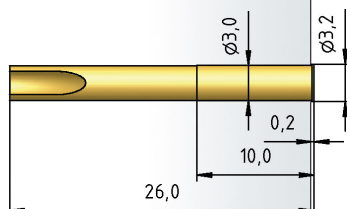

H 1050 LST



H 1050 W

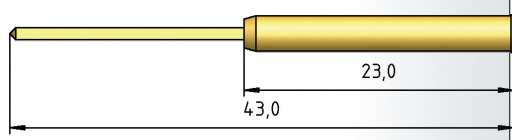

HOW TO ORDER

1053 - Y - 1.5 N E - Ni - 5.0x 1.0 C

1 2 3 4 5 6 7 8

- 1. Series 2. Tip Style 3. Spring Force
- 4. High Temperature 5. Tip Plating 6. Tip Diameter
- 7. Tip Thickness 8. Tip Material (only for CuBe)