

**Technical Data // Series 5104**

Push-Back Test Probe, Non-Rotating, 160 mil / 4.0 mm

**HIGHLIGHTS**

Push-back test probe for the cable harness test

Especially suitable for spade-shaped tip style

Non-rotating variant

Receptacle with switch function

**MECHANICAL DATA**

Center	4.00 mm/160 mil
Temperature range	-30 °C - +120 °C
Full travel	7.00 mm
Working travel	5.00 mm
Switching travel	3.50 mm
Pre-loaded spring force	0.50/ 1.00/ 1.50/ 3.00/ 4.00/ 3.00/ 4.50/ 5.00/ 4.00/ 9.00 N
Spring force at switching travel	0.70/ 3.80/ 4.65/ 7.90/ 9.10/ 11.40/ 13.95/ 15.50/ 18.70/ 23.70 N
Spring force at working travel (without switching element)	0.75/ 5.00/ 6.00/ 10.00/ 11.25/ 15.00/ 18.00/ 20.00/ 25.00/ 30.00 N
Spring force at working travel (with switching element)	+0.75 N

**ELECTRICAL DATA****Barrel-Probe Tip**

Max. current rating	20.0 A
Typical continuity resistance	<= 3 mOhm

**Connector Probe Tip**

Max. current rating	1.0 A
Typical continuity resistance	<= 30 mOhm
Typical insulating voltage	1000 V

**MATERIALS**

Barrel	Brass, gold-plated
Spring	Spring Steel, gold-plated
Plunger	Steel
Receptacle	Brass, gold-plated

**RECOMMENDED DIAMETER OF DRILL**

HP 2361.1 (trolitax)	3.50 mm
----------------------	---------

(Tolerances dependent on carrier material, test drilling is recommended)

**AVAILABLE SCREW TOOLS**

Article Designation	max. Tip Diameter
WFSB 1060/G-4.0-3.0	3.0
WFSB 1060/G-5.0-4.0-Z	4.0
WFSB 1060/G-6.0-5.0-Z	5.0



# Technical Data // Series 5104

Push-Back Test Probe, Non-Rotating, 160 mil / 4.0 mm

## TIP STYLE - DIAMETER - PLATING



**A**  
2.50 Au  
3.00 Au  
4.00 Au

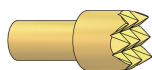

**C**  
2.40 Au  
3.00 Au  
4.00 Au  
4.80 Au



**D**  
1.75 Au  
1.80 Au  
2.00 Au  
2.30 Au  
3.00 Au  
3.70 Au

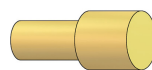

**F**  
1.80 Au  
2.00 Au  
3.00 Au  
4.00 Au



**F**  
1.40 Au

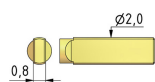

**Y**  
2.00 x 0.80 Au

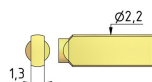

**Y**  
2.20 x 1.30 Au

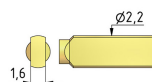

**Y**  
2.20 x 1.60 Au

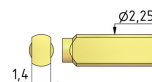

**Y**  
2.25 x 1.40 Au

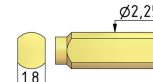

**Y**  
2.25 x 1.80 Au

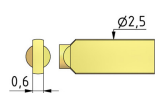

**Y**  
2.50 x 0.60 Au

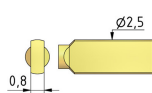

**Y**  
2.50 x 0.80 Au

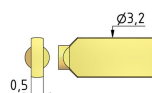

**Y**  
3.20 x 0.50 Au

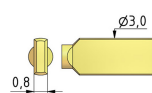

**Y1**  
3.00 x 0.80 Au

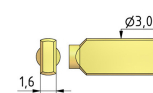

**Y1**  
3.00 x 1.60 Au

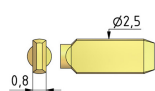

**Y2**  
2.50 x 0.80 Au

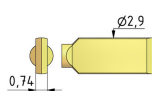

**Y4**  
2.90 x 0.74 Au

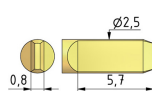

**Y21**  
2.50 x 0.80 Au

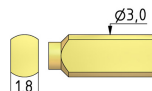

**Y95**  
3.00 x 1.80 Au

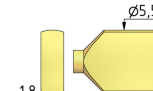

**Y95**  
5.50 x 1.80 Au

Connectorpin-Ø X/mm	Connector Pin Length Y/mm
0.5	6.0
0.7	7.0
1.0	2.5
1.0	4.0



# Technical Data // Series 5104

Push-Back Test Probe, Non-Rotating, 160 mil / 4.0 mm

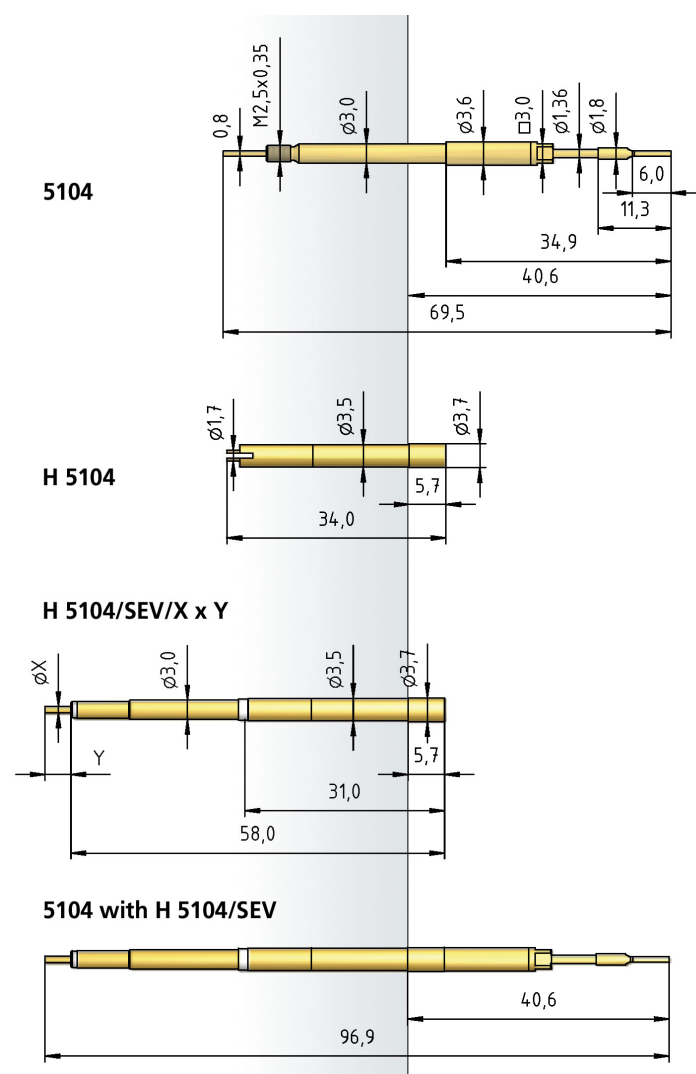

## HOW TO ORDER

5104 - Y - 15.75 N - Au - 2.2x 1.6 - /1.0x4.0

1	2	3	4	5	6	7
---	---	---	---	---	---	---

- 1. Series 2. Tip Style 3. Spring Force
- 4. Tip Plating 5. Tip Diameter 6. Tip Thickness
- 7. Complete with Switching Element