

Teknik Veriler // **Seri 1053**

Dönmeyen Test Probu 160 mil / 4.0 mm

Öne Çıkanlar

Anti-dönüş özelliği, piston ve namlu arasında zorunlu kılavuzluk sağlar

Namlu üzerindeki tırtıklı bölüm, test probunun güvenli bir şekilde oturmasını garanti eder

MEKANİK VERİ

merkez	4,00 mm/160 mil
Sıcaklık aralığı	-30 °C - +120 °C
Tam seyahat	5,00 mm
Çalışma seyahati	4,00 mm
Önceden yüklenmiş yay kuvveti	0,50/ 0,80/ 1,25 K
Çalışma yolculuğunda yay kuvveti	1.50/ 3.00/ 5.00 K

ELEKTRİKSEL VERİ

Maks. Güncel Beğeni	8,0 A
Tipik süreklilik direnci	<= 30 mOhm

MALZEMELER

Varil	Pirinç, altın kaplama
Bahar	Yay Çeliği, Paslanmaz Çelik, altın kaplama
piston	Küp
priz	Pirinç, altın kaplama

ÖNERİLEN MATKAP ÇAPI

HP 2361.1 (trolitaks)	3,00 mm
HGW 2372 (cam dolgulu malzeme)	3,00 mm

YÜKSEK SICAKLIK UYGULAMALARI

Sıcaklık aralığı	-40 °C - +250 °C
Önceden yüklenmiş yay kuvveti	0,50 N
Çalışma yolundaki yay kuvveti (Sipariş endeksi E)	1.50 N

Teknik Veriler // **Seri 1053**

Dönmeyen Test Probu 160 mil / 4.0 mm

UÇ STİLİ - ÇAP - KAPLAMA

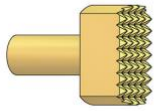

CY

6.00 x 3.00C Au

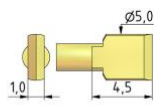

Y

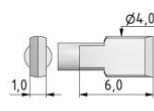
5.00 x 1.00C Au
5.00 x 1.00C Ni

Y4

4.00 x 1.00C Ni

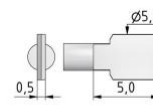

Y3

5.00 x 0.50C Ni

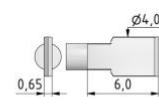

Y5

4.00 x 0.65C Ni

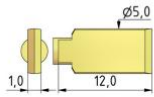

Y8

5.00 x 1.00C Au

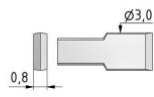

Y10

3.00 x 0.80C Ni

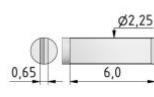

Y11

2.25 x 0.65C Ni

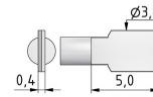

Y14

3.80 x 0.40C Ni

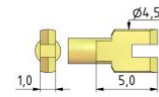

Y15

4.50 x 1.00C Au

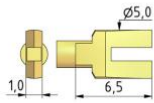

Y16

5.00 x 1.00C Au

Teknik Veriler // Seri 1053

Dönmeyen Test Probu 160 mil / 4.0 mm

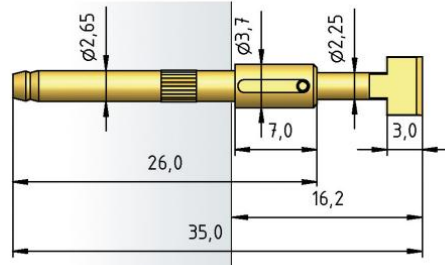
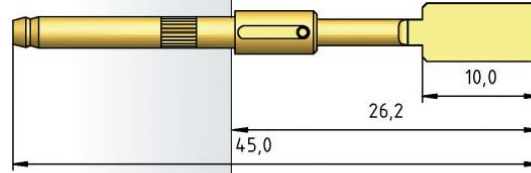
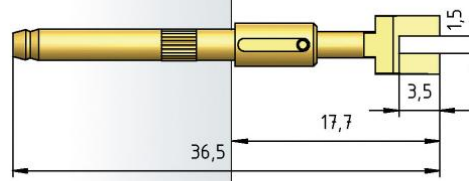
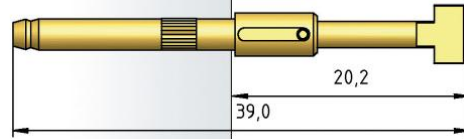
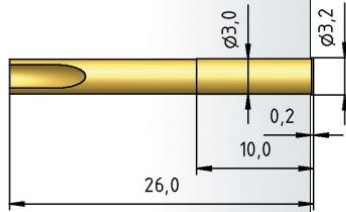
1053-Y
 (also for Tip Styles
 Y4 / Y15 / CY)

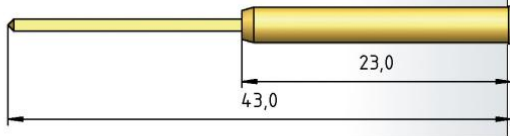
1053-Y8

1053-Y16

1053-Y3
 (also for Tip Styles
 Y5 / Y10 / Y11 / Y14)

H 1050 L

H 1050 LST

H 1050 W

NASIL SİPARİŞ VERİLİR

1053 - Y - 1.5 KD - Ni - 5.0x 1.0 C

1 2 3 4 5 6 7 8

 1. Seri 2. Uç Stili 3. Yay Kuveti 4.
 Yüksek Sıcaklık 5. Uç Kaplama 6. Uç Çapı 7. Uç
 Kalınlığı 8. Uç Malzemesi (sadece CuBe için)